

**INSPECTION
CERTIFICATE**
TRACEABLE TO DKD

measure end diameter of
chamfer or taper holes

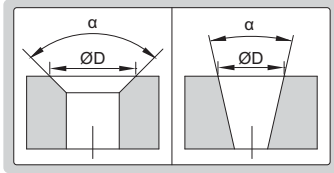

- Measure end diameter of chamfer or taper holes
- With limit pointers
- 2941-20 and 2941-203 are supplied with 5mm setting ring

Code	Range ØD	Applicable angle α	Graduation	Accuracy	Ød
2941-20 *	0.5-20.1mm	0-90°	0.01mm	±0.02mm	28.3mm
2941-40 *	20-40mm	0-90°	0.01mm	±0.02mm	50mm
2941-203 *	0.5-20.1mm	90-127°	0.02mm	±0.04mm	28.3mm
2941-403 *	20-40mm	90-127°	0.02mm	±0.04mm	50mm

* Supplied with manufacturer inspection certificate traceable to DKD Germany



2941-20

INTERNAL CHAMFER GAGES

INSIZE PLUS
MADE IN EUROPE

Unit: mm

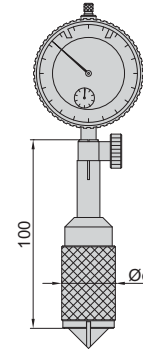

measurement principle

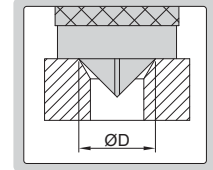

5mm setting ring for
2941-20 and 2941-203



DIGITAL INTERNAL CHAMFER GAGES

INSIZE PLUS
MADE IN EUROPE



measurement principle

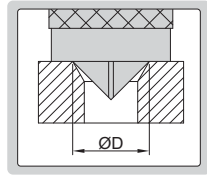

2942-20

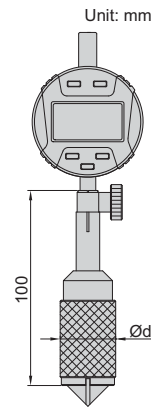

Unit: mm

DATA OUTPUT

INSPECTION CERTIFICATE
TRACEABLE TO DKD

5mm setting ring for 2942-20 and 2942-203

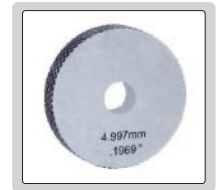

- Measure end diameter of chamfer or taper holes
- 2942-20 and 2942-203 are supplied with 5mm setting ring
- Resolution: 0.01mm/0.0005"
- Optional accessory: data output cable (code 7315-50M, 7302-40M)

Code	Range ØD	Applicable angle α	Accuracy	Ød
2942-20*	0.5-20.1mm	0-90°	±0.02mm	28.3mm
2942-40*	20-40mm	0-90°	±0.02mm	50mm
2942-203*	0.5-20.1mm	90-127°	±0.04mm	28.3mm
2942-403*	20-40mm	90-127°	±0.04mm	50mm

* Supplied with manufacturer inspection certificate traceable to DKD Germany

measure end diameter of chamfer or taper holes

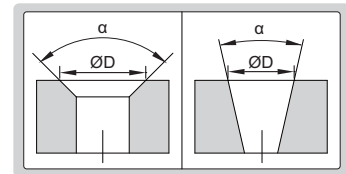

SMALL HOLE GAGE SET

- 4 gages per set
- For small holes, slots and grooves, etc.
- Satin chrome finish

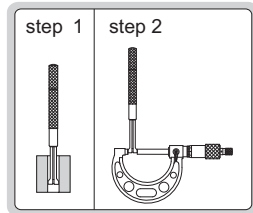

4208-1

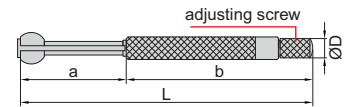

Range	L	a	b	ØD
3-5mm	76	24	52	5
5-7.5mm	79	27	52	5
7.5-10mm	88	30	58	6
10-13mm	91	34	58	6

Code	Total range	Gages included
4208-1	3-13mm	3-5mm, 5-7.5mm, 7.5-10mm, 10-13mm

TELESCOPING GAGE SET

- 6 gages per set
- For quick measurement of inside diameter of holes and width of slots
- Satin chrome finish

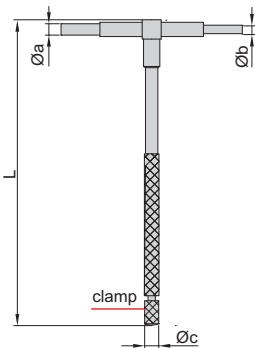

4206-1

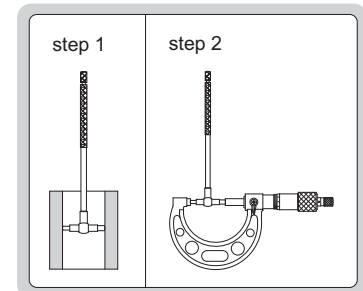

Range	L	Øa	Øb	Øc
8-12.7mm	115	3.9	2.9	6.2
12.7-19mm	115	5.3	3.8	6.2
19-32mm	115	5.3	3.8	6.2
32-54mm	137	7.6	6.1	7.2
54-90mm	137	7.6	6.1	7.2
90-150mm	137	7.6	6.1	7.2

Code	Total range	Gages included
4206-1	8-150mm	8-12.7mm, 12.7-19mm, 19-32mm, 32-54mm, 54-90mm, 90-150mm

LONG HANDLE TELESCOPING GAGES

- For quick measurement of inside diameter of deep holes and width of slots
- Satin chrome finish

(mm)

Code	Range	L	$\varnothing a$	$\varnothing b$	$\varnothing c$
4209-1	8-12.7mm	300	3.9	2.9	6.2
4209-2	12.7-19mm	300	5.3	3.8	6.2
4209-3	19-32mm	300	5.3	3.8	6.2
4209-4	32-54mm	300	7.6	6.1	7.2
4209-5	54-90mm	300	7.6	6.1	7.2
4209-6	90-150mm	300	7.6	6.1	7.2



4209-6

