

INTERCHANGEABLE ANVIL MICROMETERS

- Measure tube thickness, shoulder edge distance, rivet head height, etc.
- Supplied with flat anvil and rod anvil
- Graduation 0.01mm
- Ratchet stop
- Carbide spindle tip
- Setting standards are included (except 0-25mm)

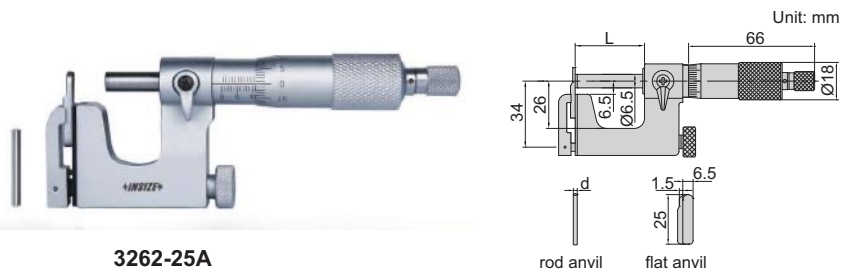

3262-25A

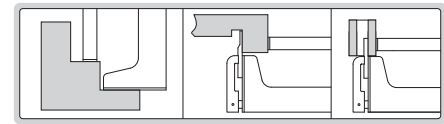

(mm)				
Code	Range	Accuracy	L	d
3262-25A	0-25mm	4µm	28.5	Ø3
3262-50A	25-50mm	4µm	53.5	Ø5

5

DIGITAL INTERCHANGEABLE ANVIL MICROMETERS

IP65 WATERPROOF

DATA OUTPUT

- Measure tube thickness, shoulder edge distance, rivet head height, etc.
- Supplied with flat anvil and rod anvil
- Resolution 0.001mm/0.00005"
- IP65 dust/waterproof
- Button function: on/off, set, mm/inch, ABS/INC
- Data output
- LR44 battery, automatic power off
- Ratchet stop
- Carbide spindle tip
- Setting standards are included (except 0-25mm/0-1")
- Optional accessory: data output cable (code 7315-30, 7302-30)



3562-25A

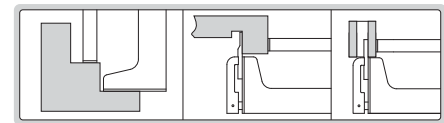
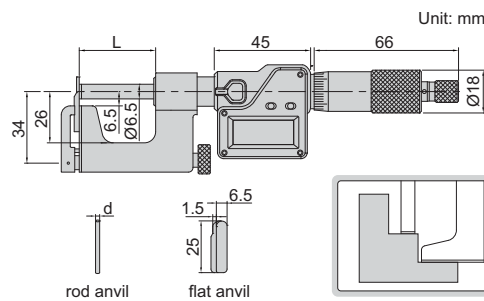

(mm)				
Code	Range	Accuracy	L	d
3562-25A	0-25mm/0-1"	±4µm	28.5	Ø3
3562-50A	25-50mm/1-2"	±4µm	53.5	Ø5

LARGE ANVIL MICROMETERS

- Graduation 0.01mm
- Ratchet stop
- Supplied with setting standards (except 0-25mm)



3234-25A

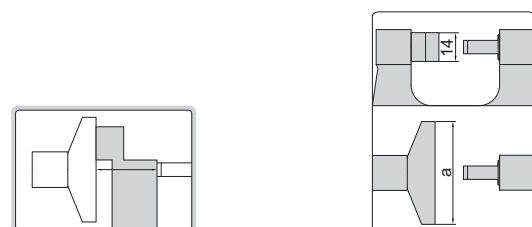
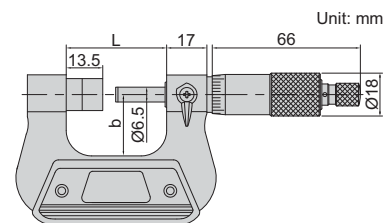

(mm)					
Code	Range	Accuracy	L	a	b
3234-25A	0-25mm	4µm	42	50	26
3234-50A	25-50mm	4µm	67	60	38

DIGITAL LARGE ANVIL MICROMETERS



3534-25A

- Resolution 0.001mm/0.00005"
- IP65 dust/waterproof
- Button function: on/off, set, mm/inch, ABS/INC
- Data output
- LR44 battery, automatic power off
- Ratchet stop
- Supplied with setting standards (except 0-25mm/0-1")
- Optional accessory: data output cable (code 7315-30, 7302-30)

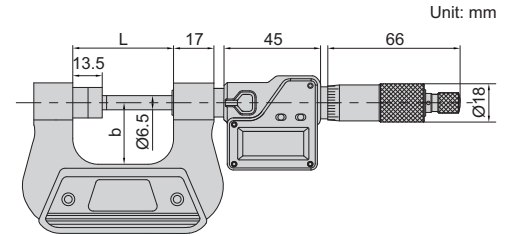

Unit: mm

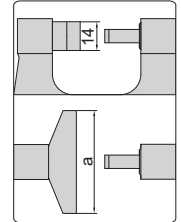
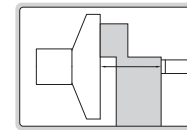

Code	Range	Accuracy	L	a	b
3534-25A	0-25mm/0-1"	±4µm	42mm	50mm	26mm
3534-50A	25-50mm/1-2"	±4µm	67mm	60mm	38mm

V-ANVIL MICROMETERS



3290-153A

- Measure the diameter of parts or cutting tools with odd grooves, such as taps, reamers and end mills
- Graduation 0.01mm
- Ratchet stop
- Carbide measuring faces
- Supplied with setting standards

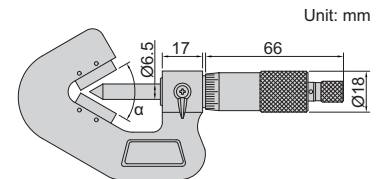

Unit: mm

Code	Range	Flutes	Accuracy	α
3290-153A	1-15mm	3	4µm	60°
3290-203A	5-20mm	3	4µm	60°
3290-353A	20-35mm	3	5µm	60°
3290-503A	35-50mm	3	5µm	60°
3290-653A	50-65mm	3	6µm	60°
3290-803A	65-80mm	3	6µm	60°
3290-953A	80-95mm	3	7µm	60°
3290-255A	5-25mm	5	4µm	108°

Code	Range	Flutes	Accuracy	α
3290-455A	25-45mm	5	5µm	108°
3290-655A	45-65mm	5	6µm	108°
3290-855A	65-85mm	5	7µm	108°
3290-1055A	85-105mm	5	8µm	108°
3290-257A	5-25mm	7	4µm	128°34'17"
3290-457A	25-45mm	7	5µm	128°34'17"
3290-657A	45-65mm	7	6µm	128°34'17"
3290-857A	65-85mm	7	7µm	128°34'17"

DIGITAL V-ANVIL MICROMETERS

IP65
WATERPROOF

DATA
OUTPUT

5

- Measure the diameter of parts or cutting tools with odd grooves, such as taps, reamers and end mills
- Resolution 0.001mm/0.00005"
- IP65 dust/waterproof
- Button function: on/off, set, mm/inch, ABS/INC
- Data output
- LR44 battery, automatic power off
- Ratchet stop
- Carbide measuring faces
- Supplied with setting standards
- Optional accessory: data output cable (code 7315-30, 7302-30)



3590-153A

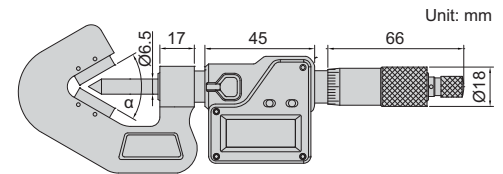

Code	Range	Flutes	Accuracy	α
3590-153A	1-15mm/0.04-0.6"	3	±4μm	60°
3590-203A	5-20mm/0.2-0.8"	3	±4μm	60°
3590-353A	20-35mm/0.8-1.4"	3	±5μm	60°
3590-503A	35-50mm/1.4-2.0"	3	±5μm	60°
3590-653A	50-65mm/2.0-2.6"	3	±6μm	60°
3590-803A	65-80mm/2.6-3.2"	3	±6μm	60°
3590-953A	80-95mm/3.2-3.6"	3	±6μm	60°
3590-255A	5-25mm/0.2-1.0"	5	±4μm	108°

Code	Range	Flutes	Accuracy	α
3590-455A	25-45mm/1.0-1.8"	5	±5μm	108°
3590-655A	45-65mm/1.8-2.6"	5	±6μm	108°
3590-855A	65-85mm/2.6-3.4"	5	±6μm	108°
3590-1055A	85-105mm/3.4-4.2"	5	±6μm	108°
3590-257A	5-25mm/0.2-1.0"	7	±4μm	128°34'17"
3590-457A	25-45mm/1.0-1.8"	7	±4μm	128°34'17"
3590-657A	45-65mm/1.8-2.6"	7	±5μm	128°34'17"
3590-857A	65-85mm/2.6-3.4"	7	±5μm	128°34'17"

NON-ROTATING SPINDLE UNIVERSAL MICROMETERS

NON-ROTATING
SPINDLE

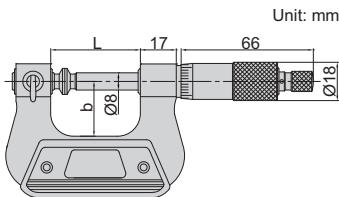

3280-25A

- Meet DIN863-3
- Graduation 0.01mm
- Non-rotating spindle
- Ratchet stop
- Supplied with 7 pairs of anvil/spindle tip
- Setting standards are included (except 0-25mm)
- Optional accessory: 55° anvil/spindle tip (code 3280-SP1 and 3280-SP2)

Code	Range	Accuracy	L	b
3280-25A	0-25mm	4μm	42mm	26mm
3280-50A	25-50mm	4μm	67mm	38mm
3280-75A	50-75mm	5μm	92mm	50mm
3280-100A	75-100mm	5μm	118mm	62mm
3280-125A	100-125mm	6μm	143mm	70mm
3280-150A	125-150mm	6μm	168mm	82mm
3280-175A	150-175mm	7μm	192mm	95mm
3280-200A	175-200mm	7μm	217mm	107mm

Anvil/spindle tip (included)

Unit: mm

Flat		
Spherical		
Spline		
Disk		
Blade		
Knife-edge		
Point		

55° anvil/spindle tip (optional)

Unit: mm

Code 3280-SP1 Knife-edge		
Code 3280-SP2 Point		